

# POOL & SPA WATER TESTS

1. Keep test kit out of reach of children.
2. Read precautions on all labels.
3. Store test kit in cool, dark place.
4. Replace reagents once each year.

5. Do not dispose of solutions in pool or spa.
6. Rinse cells/tubes before and after each test.
7. Obtain samples 18" (45 cm) below water surface.
8. Hold dropper bottle vertically when dispensing reagent.

Instr. #5117

## Free, Combined & Total Chlorine / Total Bromine Test

Test daily

**Ideal Free Chlorine Range:**  
2-4 ppm (pools or spas)

**Ideal Total Bromine Range:**  
2-3 ppm (pools) / 2-4 ppm (spas)

**Ideal Combined Chlorine:** None

### STEP 1

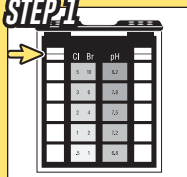

Rinse left comparator test cell and fill with sample water up to the black line.

### STEP 2

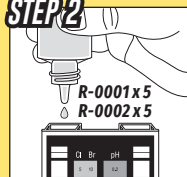

Add 5 drops R-0001 and 5 drops R-0002.

### STEP 3



Cap and invert to mix (DO NOT SHAKE).

### STEP 4

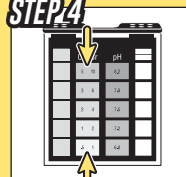

Match color with color standard. Record as parts per million (ppm) free chlorine or total bromine.

### STEP 5

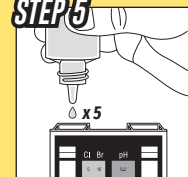

For total chlorine, use the same sample from Step 4 and add 5 drops R-0003. Cap and invert to mix (DO NOT SHAKE).

### STEP 6

Match color immediately and record as ppm total chlorine.

### STEP 7

Subtract free chlorine (FC) from total chlorine (TC). Record as ppm combined chlorine (CC). Formula:  $TC - FC = CC$ .\*

\*To raise or lower your sanitizer level, visit your local pool/spa retailer or go to [web.suretreat.com](http://web.suretreat.com) and enter your test results to see recommendations.

more below fold ↓

## pH Test

Test daily

**Ideal pH Range:** 7.4-7.6 (pools or spas)

### STEP 1

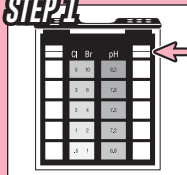

Rinse right comparator test cell and fill with sample water up to black line.

### STEP 2

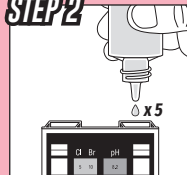

Add 5 drops R-0014.

### STEP 3



Cap and invert to mix (DO NOT SHAKE).

### STEP 4

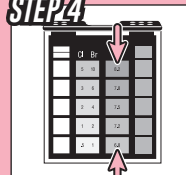

Match color with color standard. Record as pH units. If sample color is between two values, pH is average of the two.\*

\*If any adjustments are needed, contact your local pool/spa supply store for recommendations or visit [web.suretreat.com](http://web.suretreat.com).

## Acid Demand Test / Base Demand Test

### STEP 1

Use treated sample from pH test.

### STEP 2

To LOWER pH, use R-0015. To RAISE pH, use R-0016. Add appropriate reagent dropwise. After each drop, invert to mix (DO NOT SHAKE) and compare with color standards until desired pH is matched. Record number of drops needed and contact your local pool/spa supply store for recommendations.

Visit [web.suretreat.com](http://web.suretreat.com) to create an account, save your test results, and receive personalized treatment recommendations.

800-TEST KIT (837-8548)  
[www.taylor technologies.com](http://www.taylor technologies.com)

**taylor**  
rev. 042619

## Total Alkalinity Test

Test weekly

Ideal Total Alkalinity Range: 80-120 ppm (pools or spas)

### STEP 1

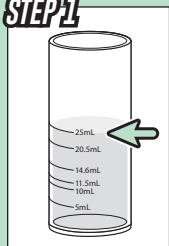

Rinse and fill sample tube (#9198) to 25 mL mark with sample water.

### STEP 2

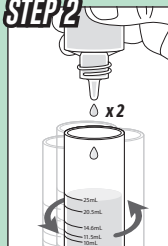

Add 2 drops R-0007. Swirl to mix.

### STEP 3

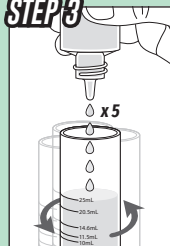

Add 5 drops R-0008. Swirl to mix. Sample will turn green.

### STEP 4

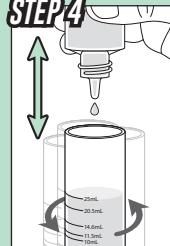

Holding bottle vertically, add R-0009 drop by drop, swirling to mix after each drop, until color changes from green to red.

### STEP 5

Multiply drops in Step 4 by 10. Record as parts per million (ppm) total alkalinity.\*

*\*To raise or lower total alkalinity, visit your local pool/spa retailer or go to [web.suretreat.com](http://web.suretreat.com) and enter your test results to see recommendations.*

## Calcium Hardness Test

Test monthly

Ideal Calcium Hardness Ranges:  
200-400 ppm (gunite pools) / 150-250 ppm (spas, above ground pools, vinyl liner pools and fiberglass shells)

### STEP 1

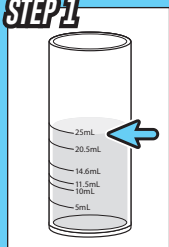

Rinse and fill sample tube (#9198) to 25 mL mark with sample water.

### STEP 2

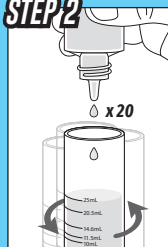

Add 20 drops R-0010. Swirl to mix.

### STEP 3

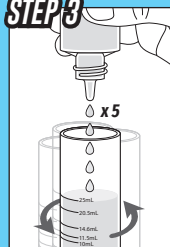

Add 5 drops R-0011. Swirl to mix. Sample will turn red.

### STEP 4

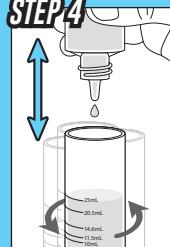

Holding bottle vertically, add R-0012 drop by drop, swirling to mix after each drop, until color changes from red to blue.

### STEP 5

Multiply drops in Step 4 by 10. Record as parts per million (ppm) calcium hardness.\*

*\*To raise calcium hardness, visit your local pool/spa retailer or go to [web.suretreat.com](http://web.suretreat.com) and enter your test results to see recommendations. To lower calcium hardness, partially drain water, and refill with fresh water of lower hardness.*

## Cyanuric Acid Test

Test monthly

Ideal Cyanuric Acid Range:  
30-50 ppm (for outdoor pools/spas)

### STEP 1

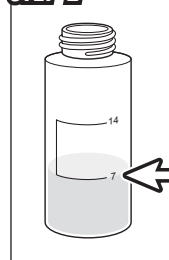

Rinse and fill bottle (#9191) to 7 mL mark with sample water.

### STEP 2

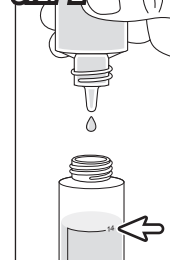

Add R-0013 to 14 mL mark. Cap and mix for 30 seconds.

### STEP 3

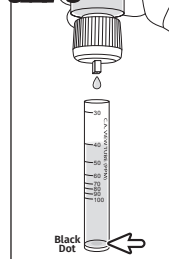

Slowly transfer cloudy solution to test tube (#9197) until black dot on bottom just disappears when viewed from the top.

### STEP 4

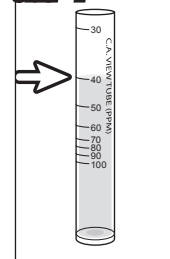

Read tube at liquid level. Record as parts per million (ppm) cyanuric acid.\*

*\*To raise or lower cyanuric acid, visit your local pool/spa retailer or go to [web.suretreat.com](http://web.suretreat.com) and enter your test results to see recommendations.*